

# MARMARA TEKNİK

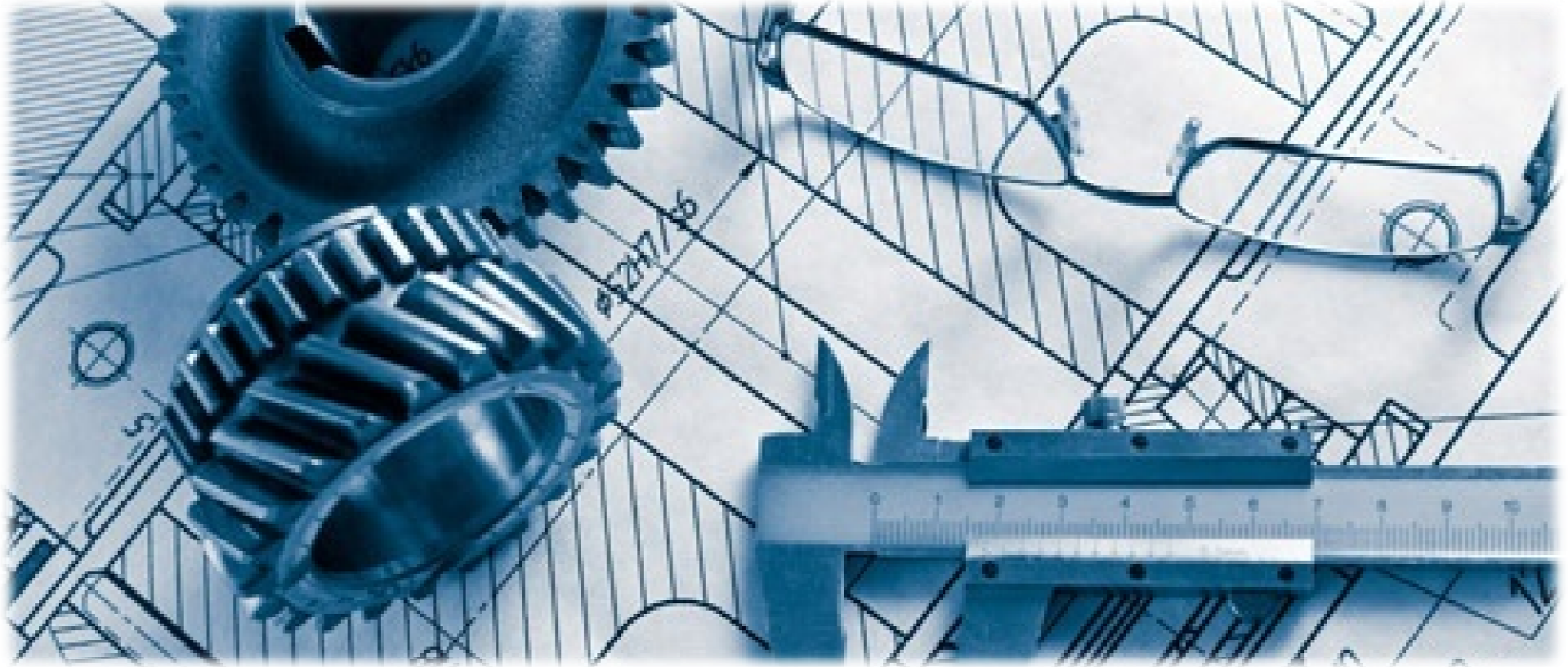

Adress: SANAYI MAH. MARTI SOK.NO:47 IZMIT/KOCAELI

Phone: +90 262 335 0177

Telefax:+90 262 335 1802

[www.marmarateknikmakina.com.tr](http://www.marmarateknikmakina.com.tr)

E-mail: [info@marmarateknikmakina.com.tr](mailto:info@marmarateknikmakina.com.tr)

What we do;

Assembly machines, fixtures

Control fixtures,

Blow Molding Parts cutting fixtures

Paper Molds

Turn Tables

Conveyors

Facililites for automotive industry

Stillages (pallets-delivery and stock pallets)

A background image showing two hands cupping a small globe of the Earth, symbolizing care, protection, and global reach.

**Mission :** To be a solution partner for our costumers with our lean and high-technological products and services.

**Vision :** To be a global company by following innovative and progressive thinking approach and provide distinctive solutions to customers in future as today.

- General Manager : 1
- Project Development and Design Manager : 1
- Engineering and Manufacturing Manager : 1
  - Mechanical Designer : 2
  - Mechanical Engineer : 2
    - Administration: 2
  - Mechanical Technician: 2
    - Craftmans: 3
    - Lathe Operator : 2
    - Milling Operator: 2
    - CNC Operator: 2
- Manufacturing and Assembly: 19

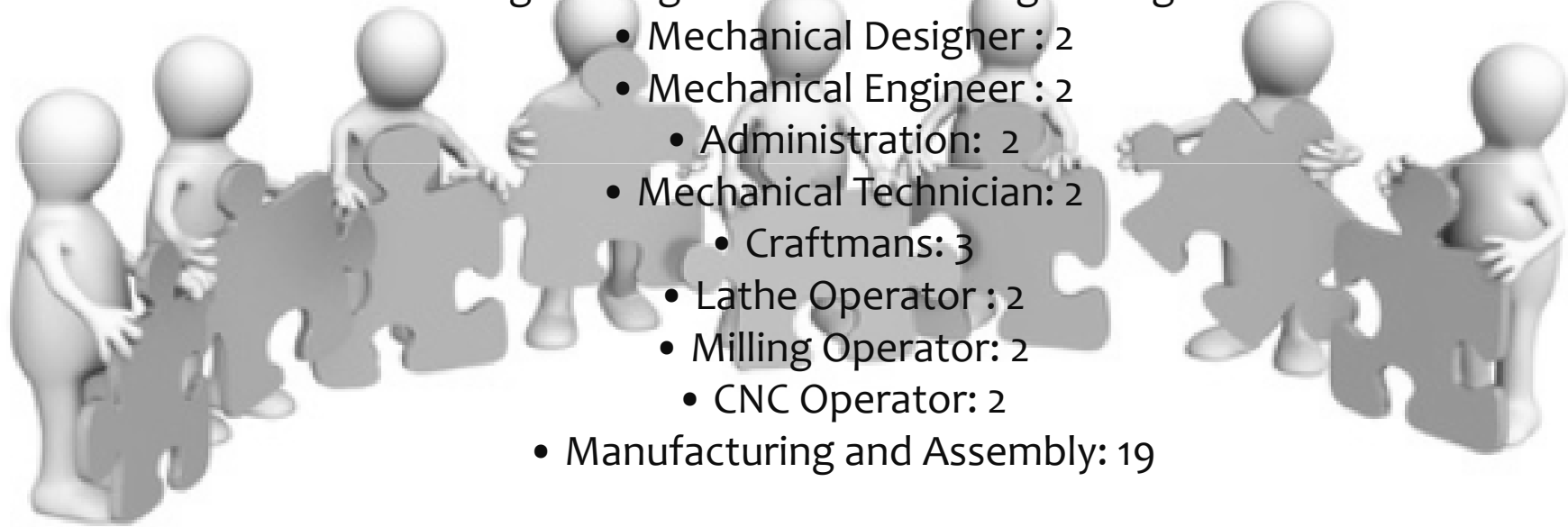

- 1-CNC DIK ISLEME MERKEZİ
- 2-SC-300 CNC TEZGAHI (SURPLEX)
- 3-METAL ISLEME MER.(GOLDMASTER)
- 4-KALIPCI FREZE TEZSAN
- 5-ZAYER FREZE
- 6-NOLL FREZE
- 7-TORNA 1,5 m, 2m, 4m (3 adet)
- 8-PLAZMA KESME
- 9-CNC TORNA TEZGAHI
- 10-ABKANT BÜKME
- 11-BURLA GAZALTI KAYNAK MAKİNASI
- 12-GİYOTIN MAKAS
- 13-ÜNVER TORNA TEZGAHI
- 14-K-160 EL ÇANTA KAYNAK MAKİNASI
- 15-K-160 EL ÇANTA KAYNAK MAKİNASI
- 16-PUNTA KAYNAK MAKINASI
- 17-BOSCH TASLAMA MOTORU
- 18-K-140 EL KAYNAK MAKINASI
- 19-5 TON VİNÇ ARABALI
- 20-10 TON ÇİFT KİRİŞ ARABALI VİNÇ
- 21-10 TON ÇİFT KİRİŞ ARABALI VİNÇ

## VISUALS – MACHINERY POOL





WELDING AREA



ASSEMBLY AREA



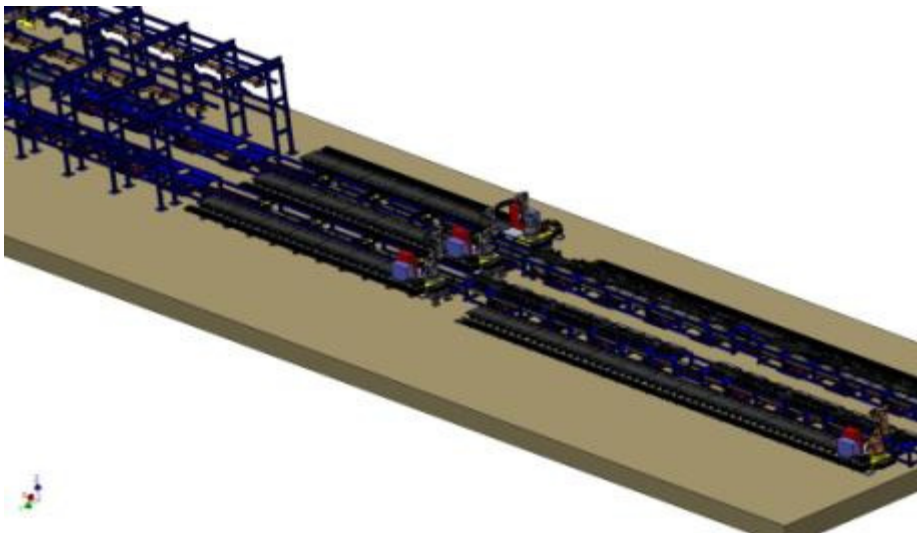
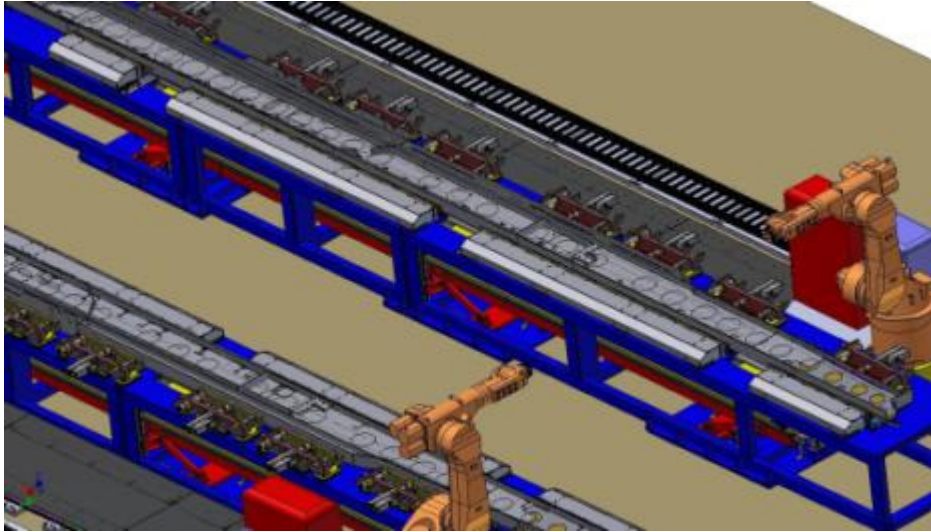

ULS TRAILER LONJERON WELDING LINE



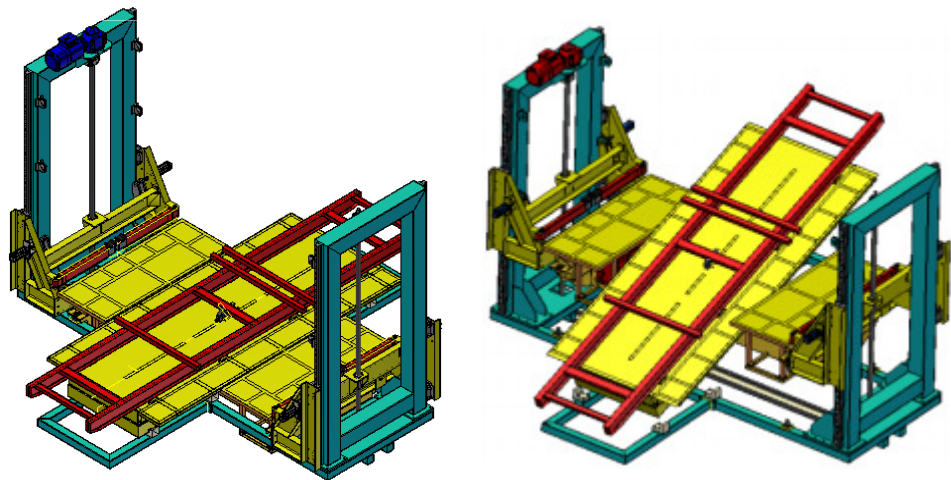
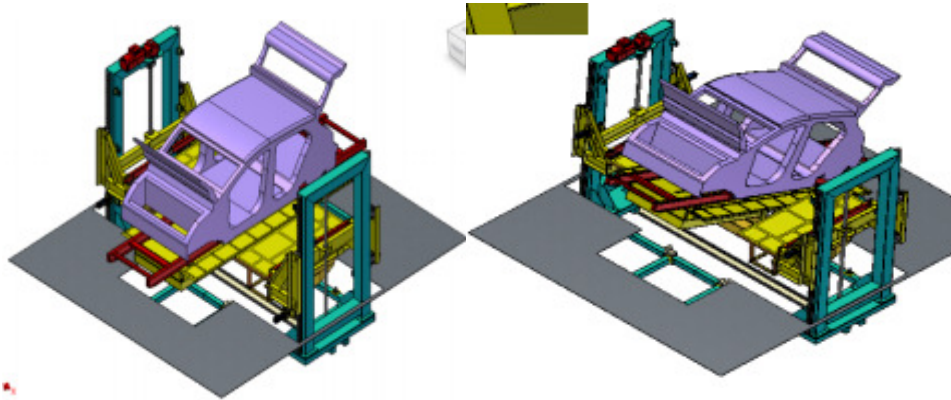

RUSSIA LADA TILTING MACHINE

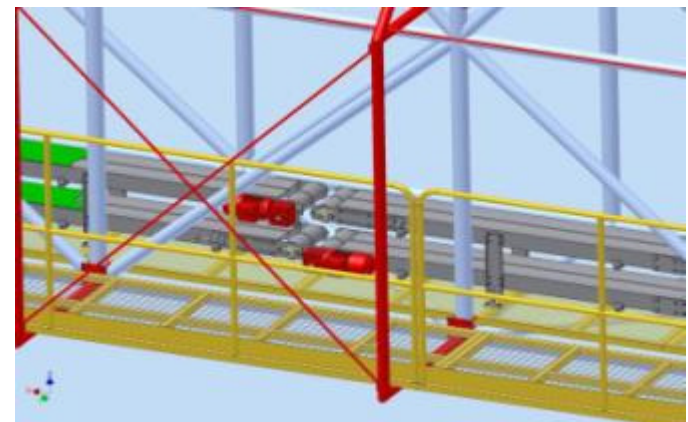
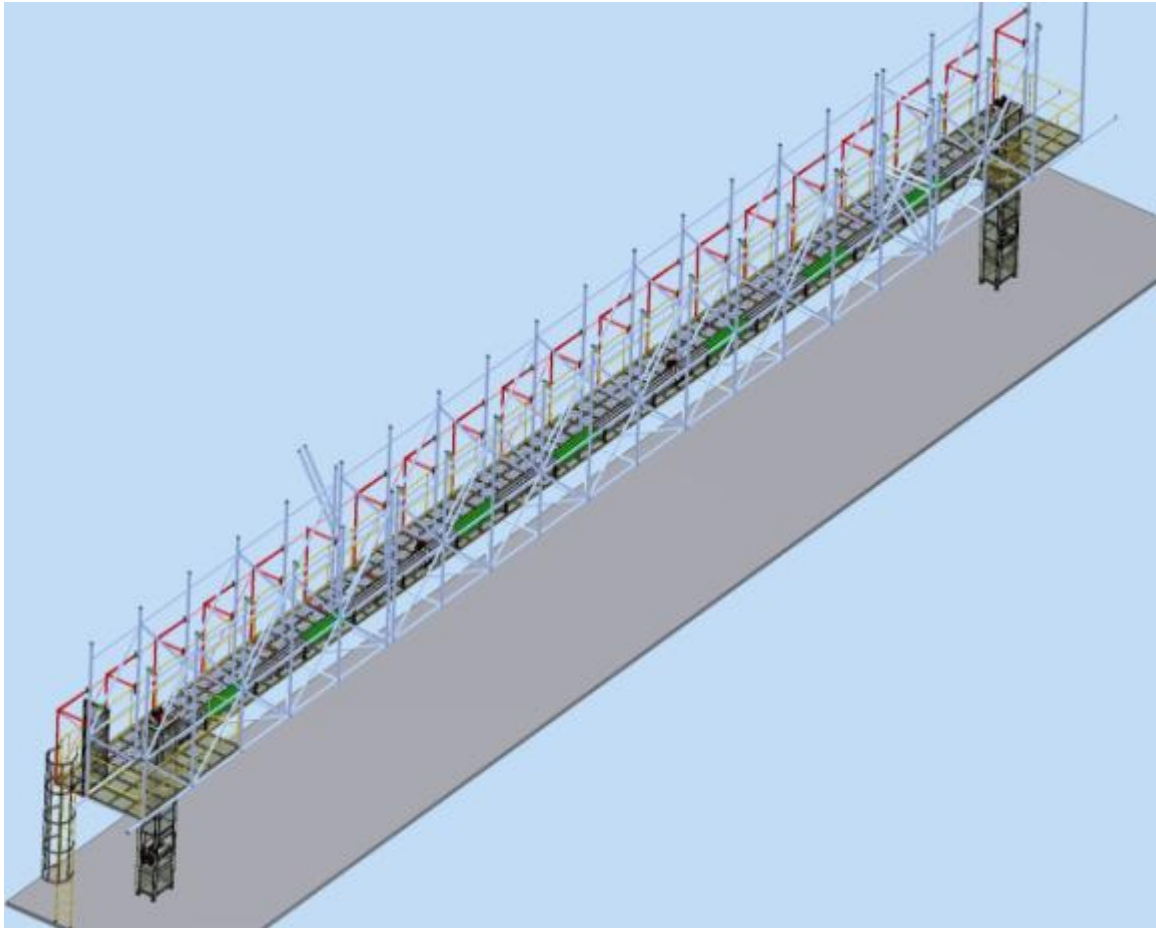

FORD ECAST TRANSFER CONVEYOR SYSTEM



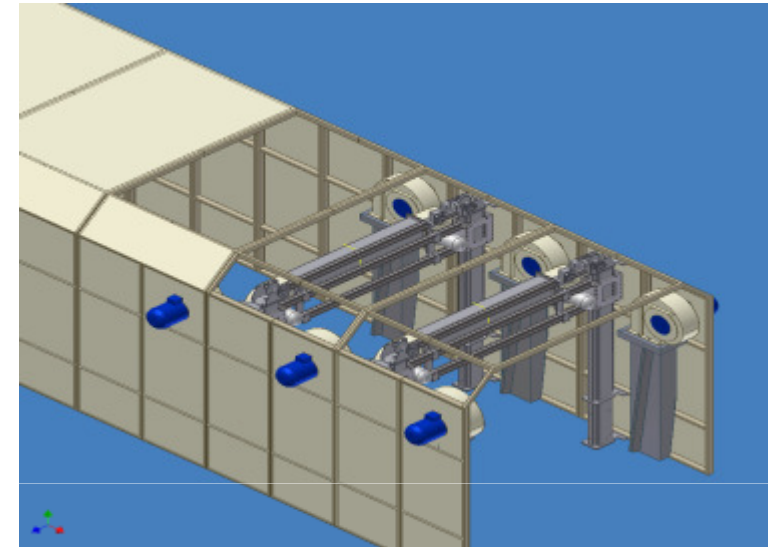
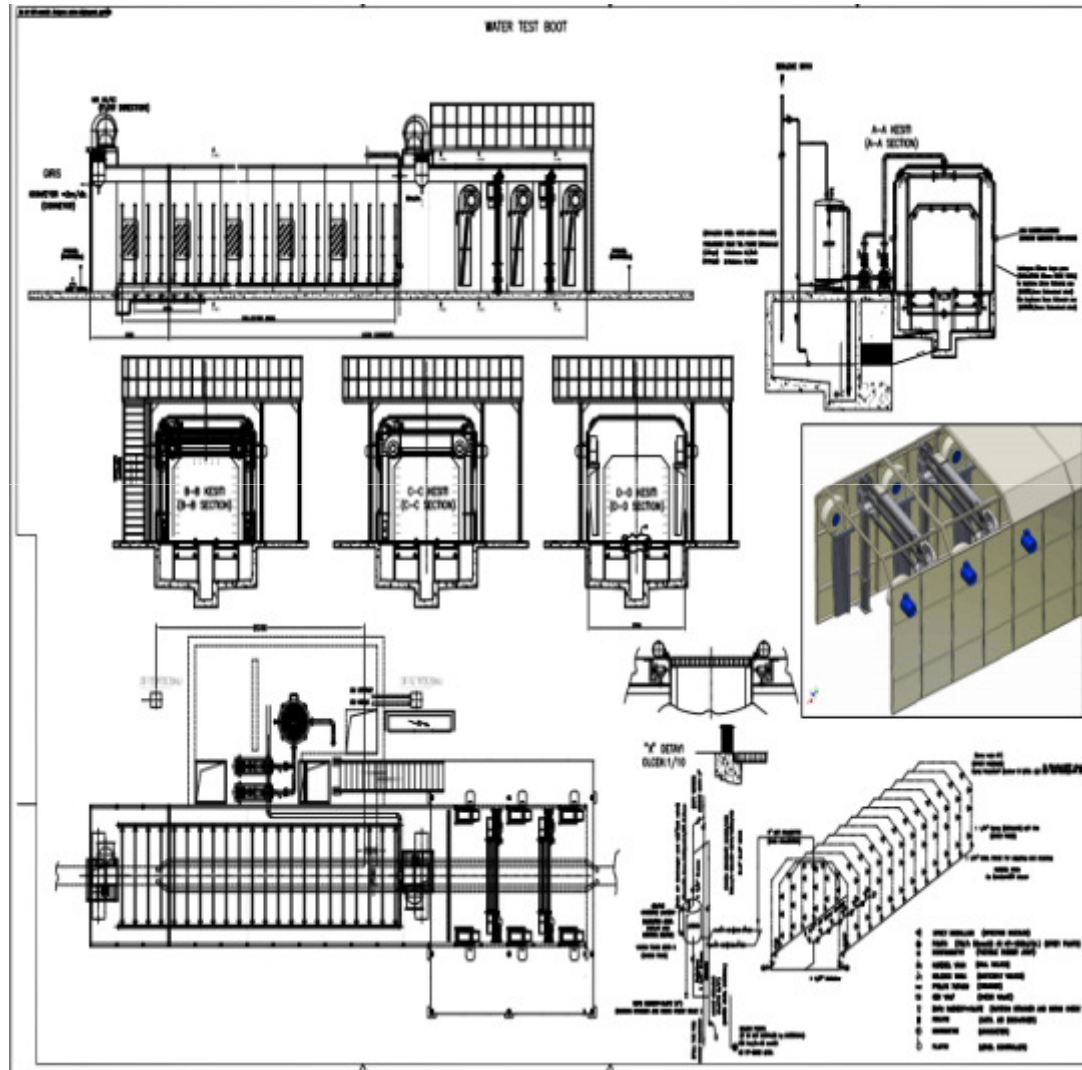

HYUNDAI WATER TEST LINE



ABB TRANSFORMER ASSEMBLY MACHINE (FOR 9 TON)





SILIDING DOOR SEAL MACHINE

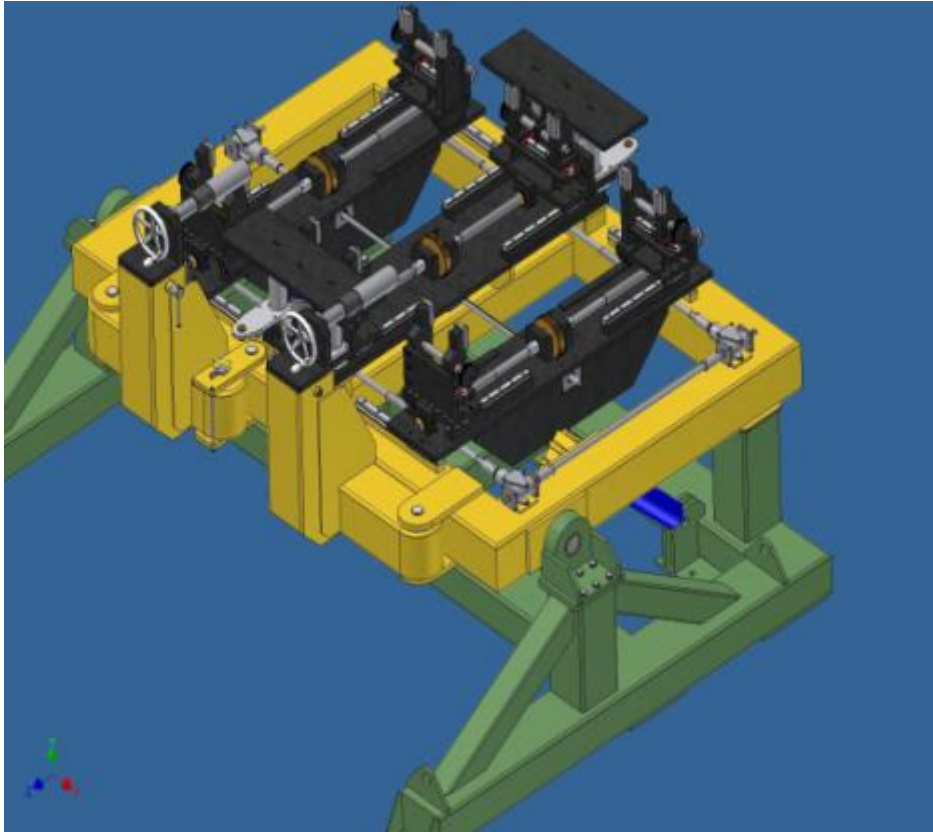
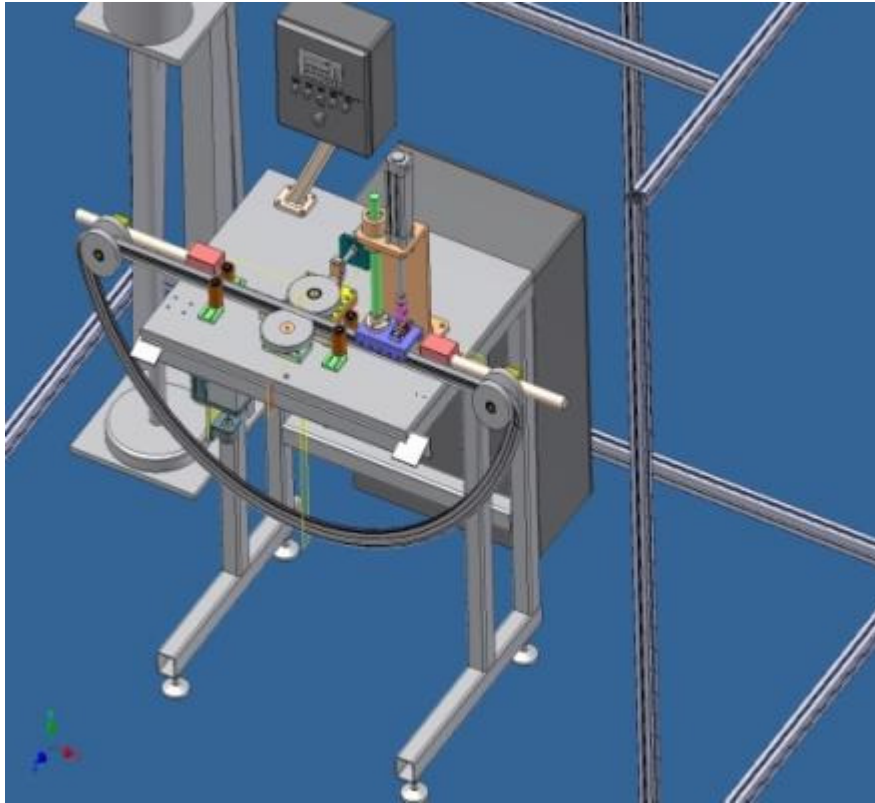
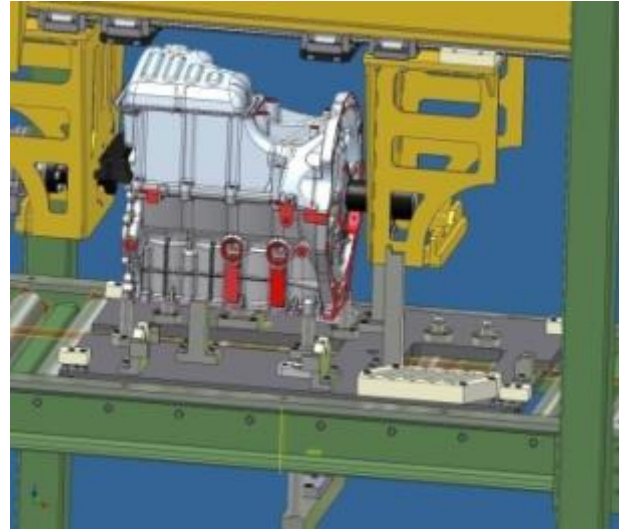
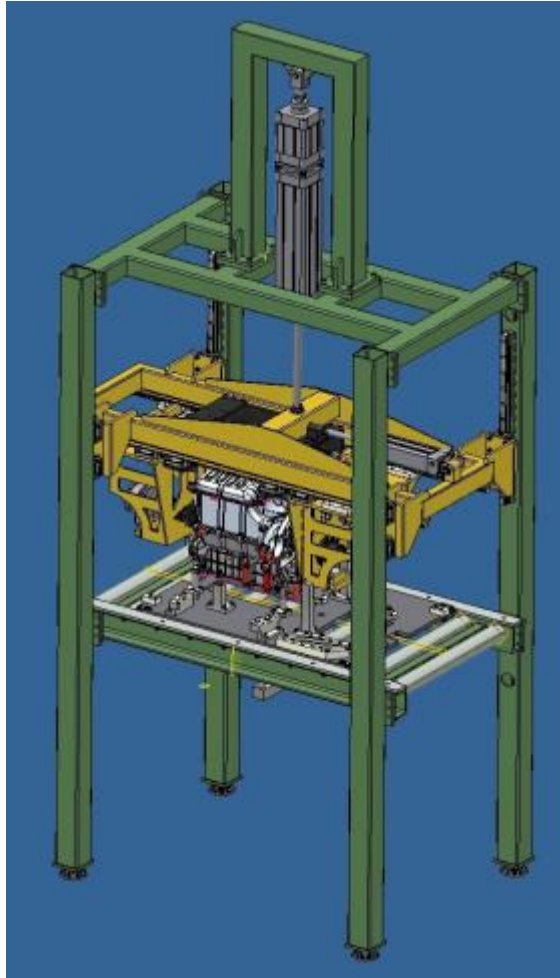

C-BLOCK TURNING MACHINE



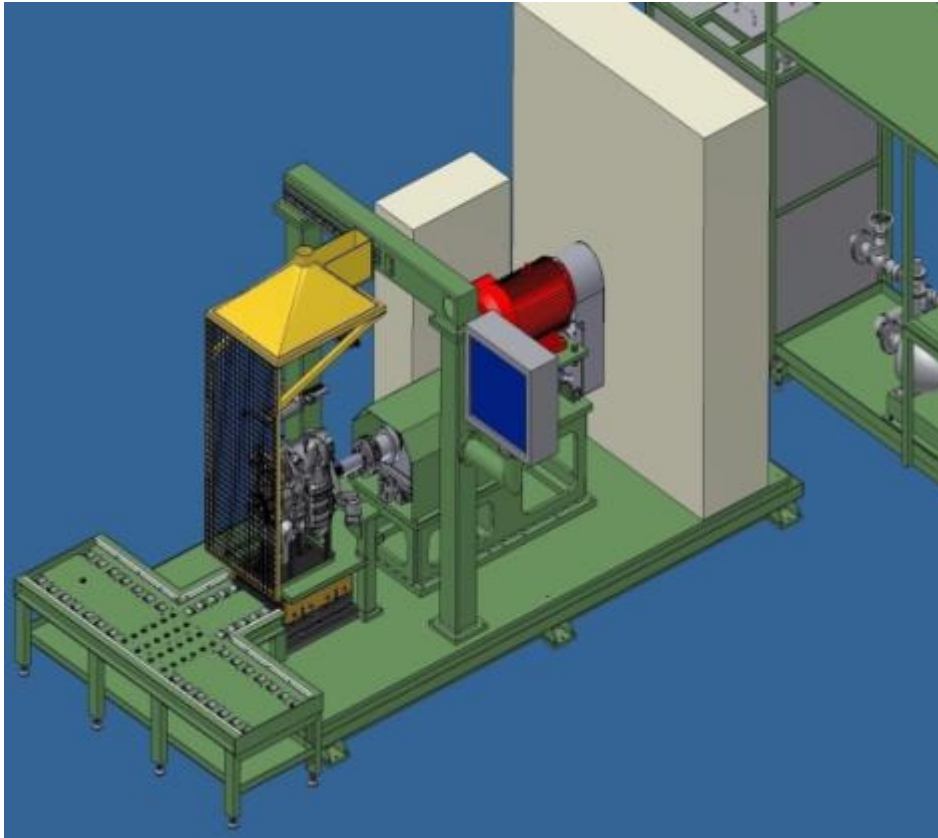

ENGINE TEST BENCH MACHINE

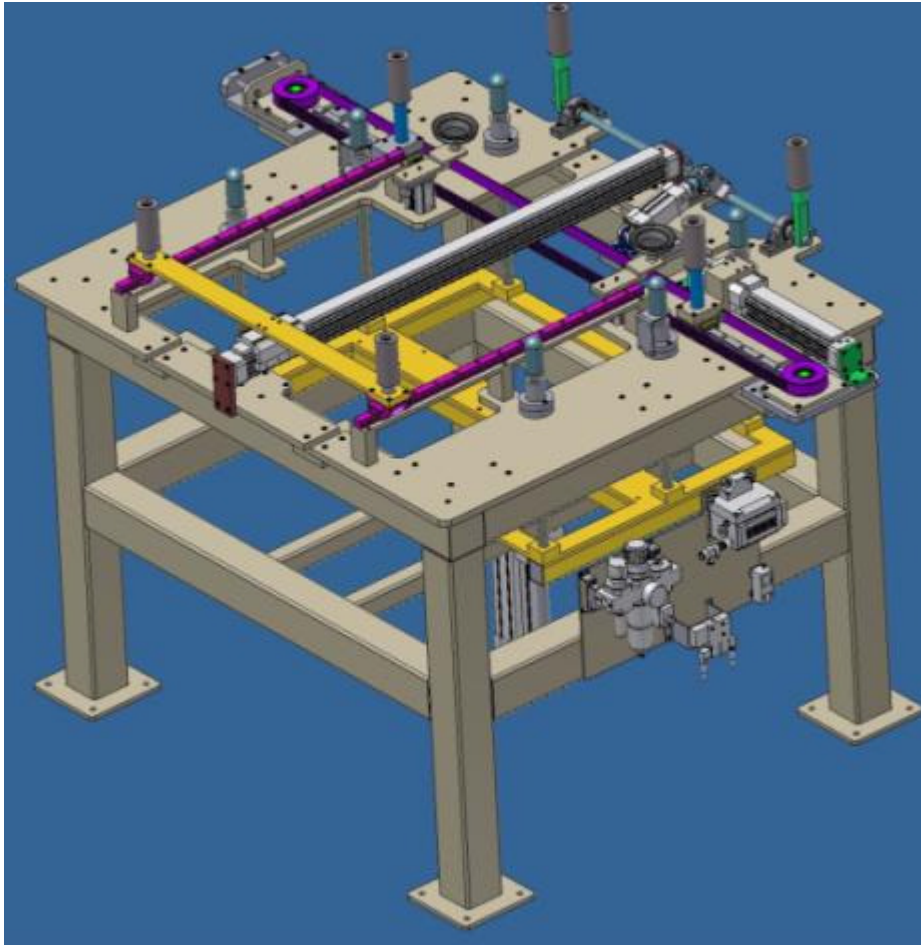

FRT GLASS SEALER FIXTURE



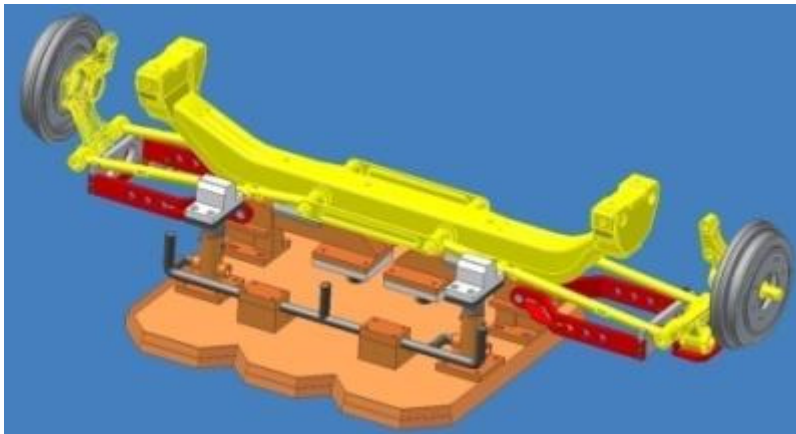
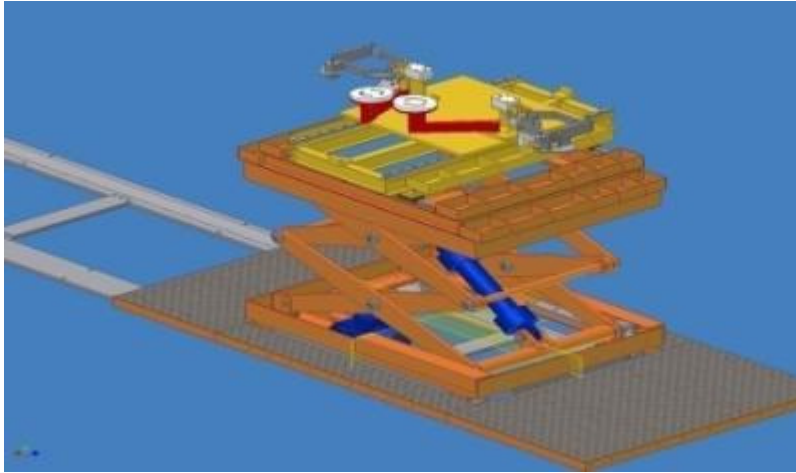

REAR AXLE ASSEMBLE DECKING LIFT



STRUT LOADER MANIPLATOR JIG



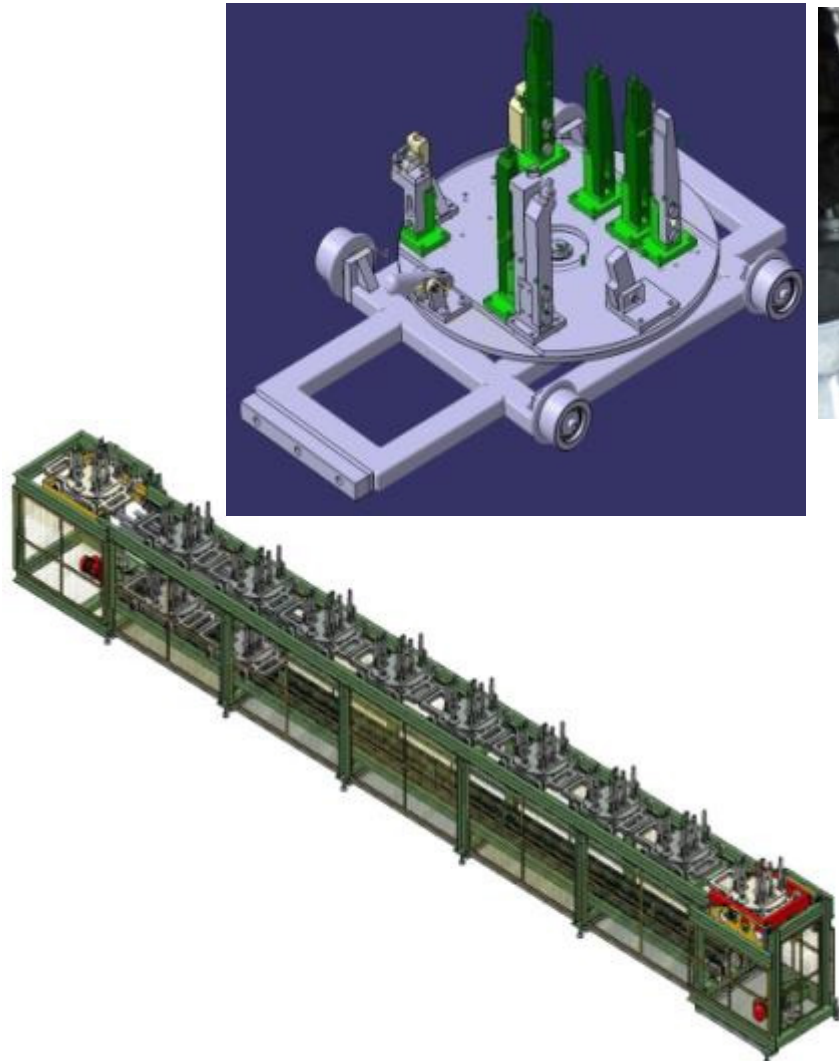

ENGINE SUB ASSEMBLY LINE

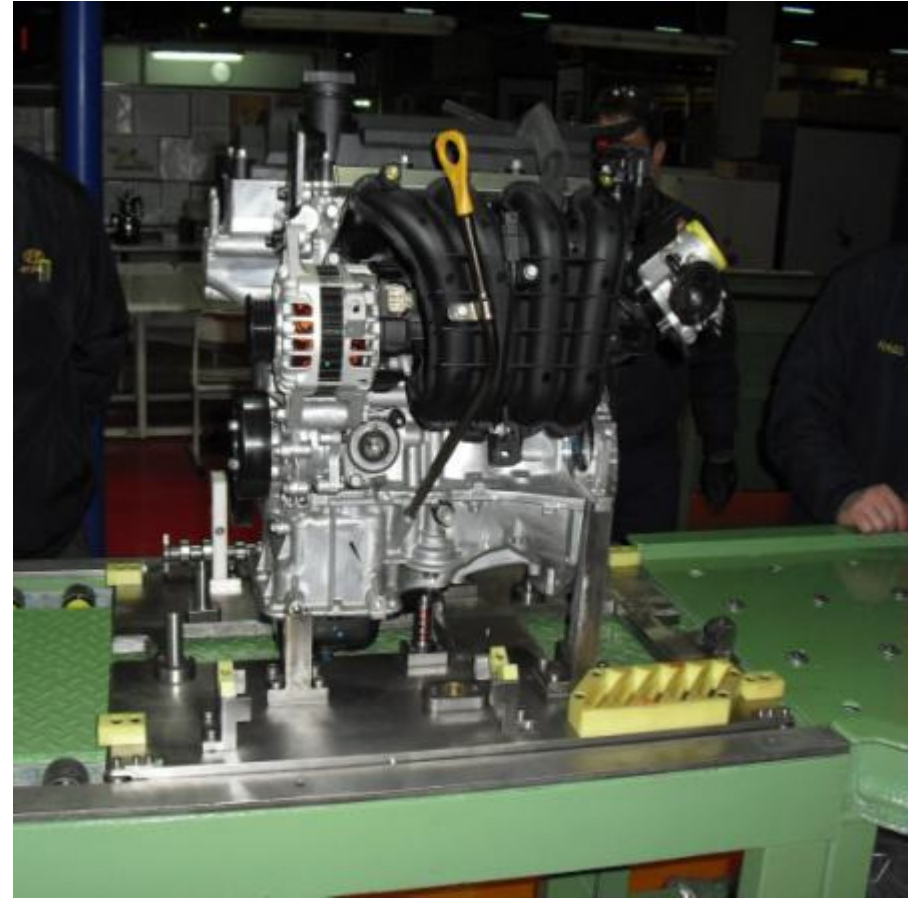
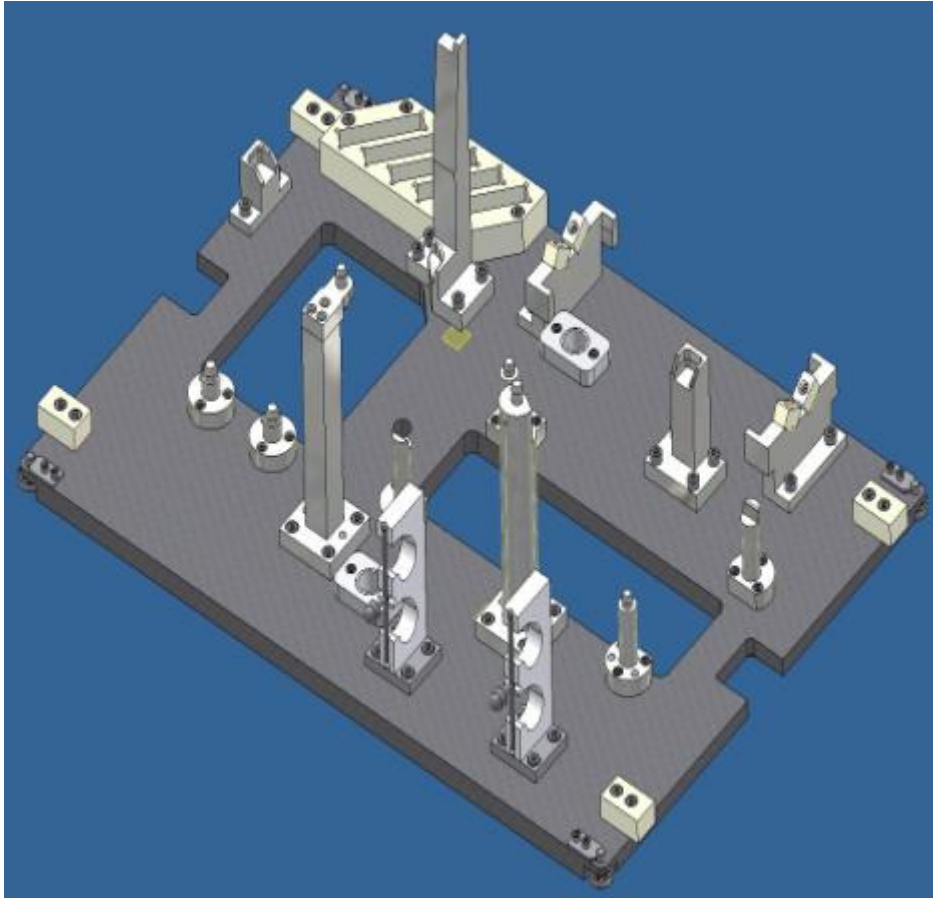

I20 KAPPA ENGINE ASSEMBLY FIXTURE



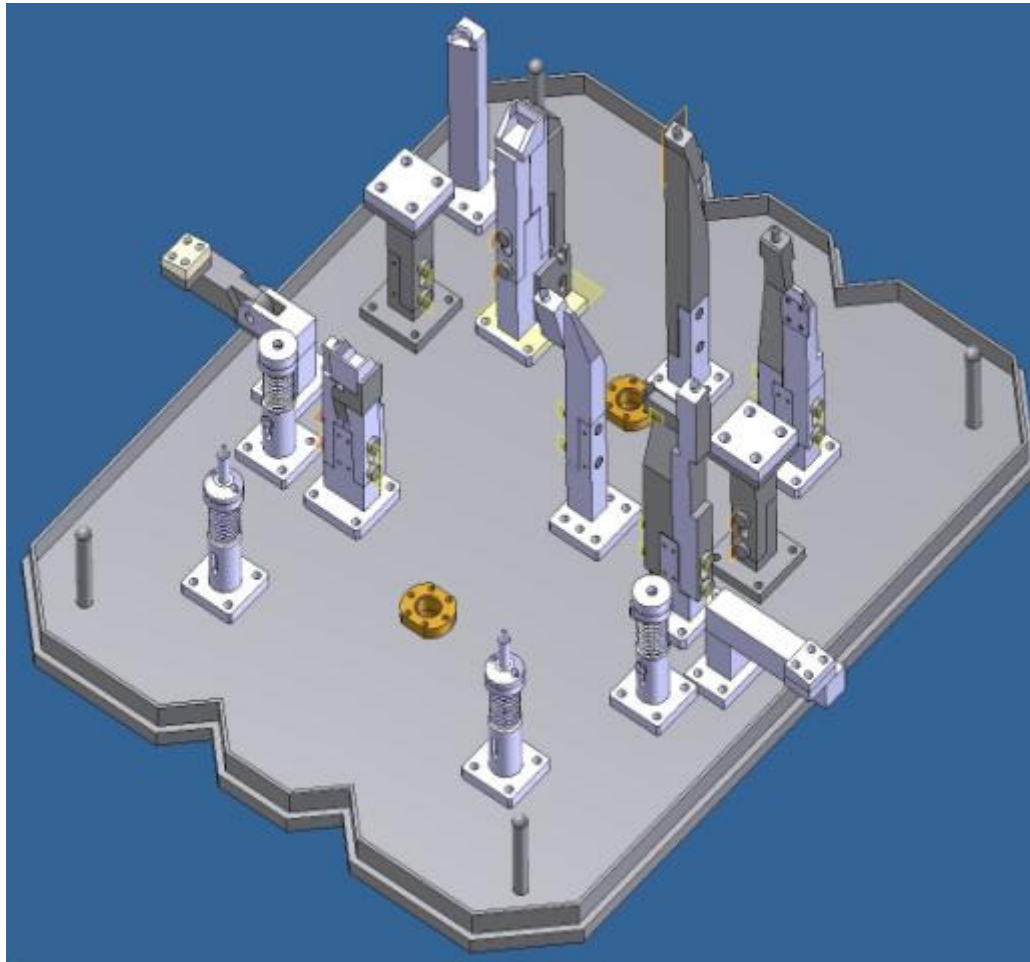

ACCENT FRT SUSP.ASSEMBLY FIXTURE



ASSEMBLY LINE CHASSIS HANGER



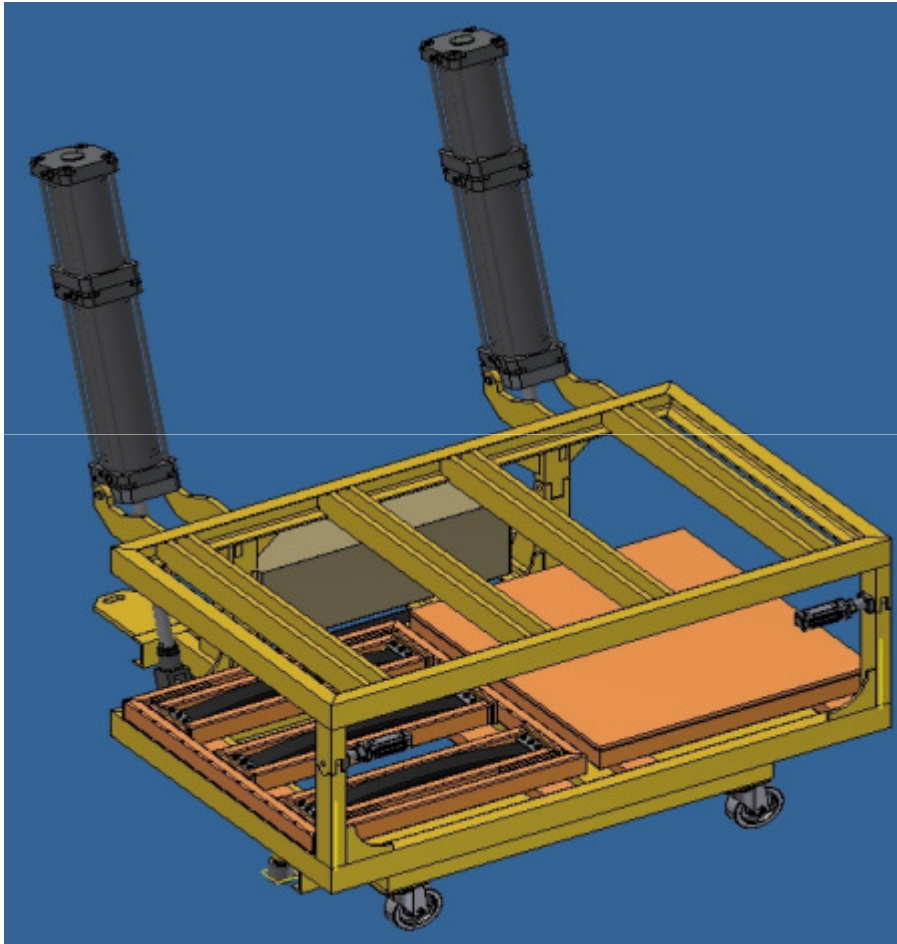

HANIL CF DIE/TOOL TROLLEY

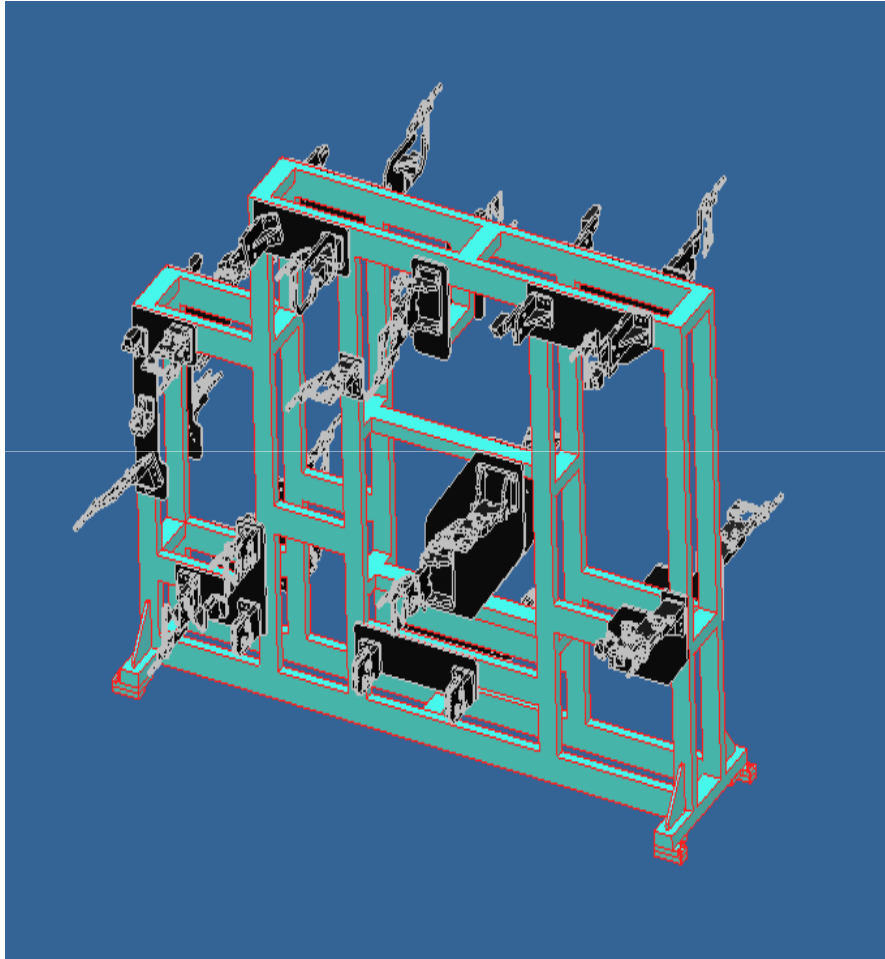

- BODY SIDE FIXTURE





- COVEYOR IN SVO OVEN 230 °C



- WELDING SKID



## REFERENCES

MARMARA TEKNİK



# Customers

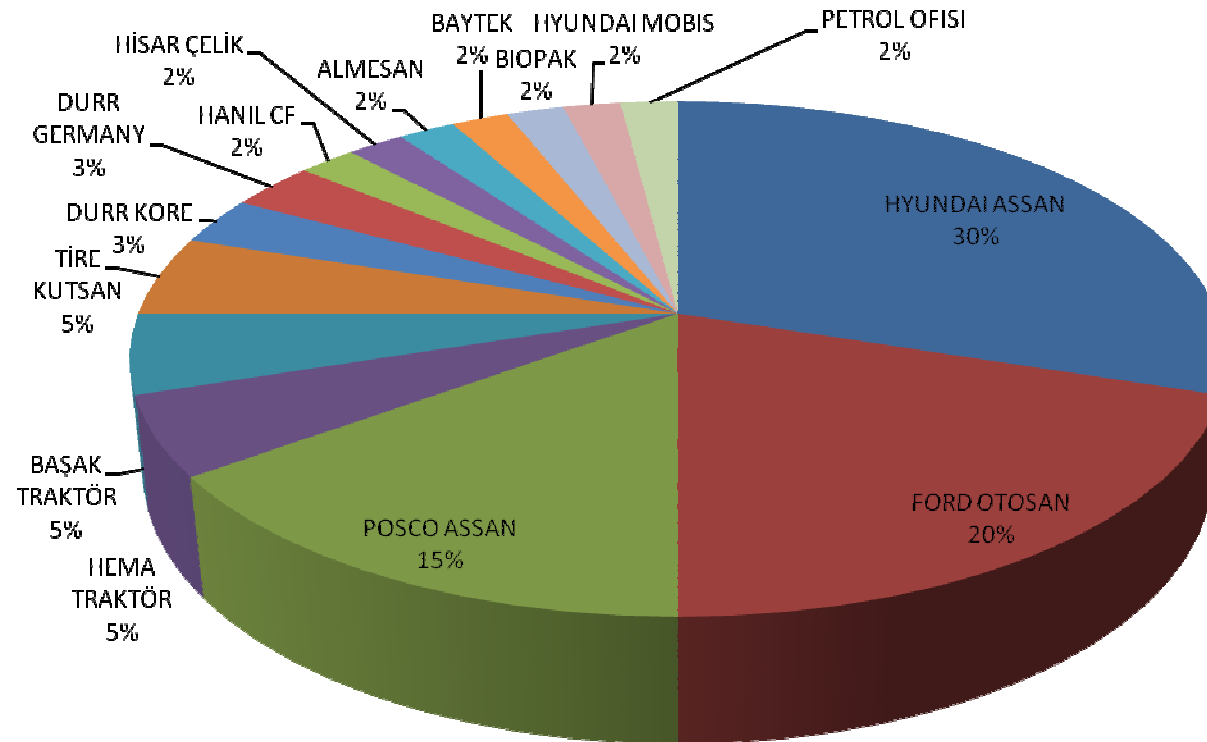



Tesekkürler  
Thanks...



President  
Hüseyin SALIHOGLU